



G SERIES SANITARY CLAMP (PRECISION TURBINE METERS)

The G Series High Precision Meter is the most accurate of all the FLOMEC® Turbine Meters:

FEATURES / BENEFITS

- Meter includes a traditional design
- Available in a variety of sizes

APPLICATIONS

- Fuel
- Batching
- Food & Beverage
- Petro Chemicals
- Pharmaceuticals
- Thin Viscosity Fluids Under 100 Centipoise
- Process Control
- Chemical Feed Lines
- Irrigation
- High Water Volume Mixing
- High Precision / High Pressure

PRODUCT CONFIGURATION

PRODUCT IDENTIFIER **1**

G = G Series Precision Turbine Meter

FITTING TYPE **2**

SC = Sanitary Clamp

SHAFT / SLEEVE BEARING / THRUST BEARING **3**

P = Stainless Steel / PTFE / 440C Stainless Steel

TURBINE SIZE & FLOWRATE **4**

- 05175 = 1/2" Turbine, 3/4" Fitting, Low Flow
- 05110 = 1/2" Turbine, 1" Fitting, Low Flow
- 07515 = 3/4" Turbine, 1-1/2" Fitting, Standard
- 075E15 = 3/4" Turbine, 1-1/2" Fitting, Ext-Range
- 10015 = 1" Turbine, 1-1/2" Fitting, Standard
- 15015 = 1-1/2" Turbine, 1-1/2" Fitting, Standard
- 20020 = 2" Turbine, 2" Fitting, Standard

SENSOR CHOICE **5**

X = No Sensor - Turbine Body Only

ELECTRONIC CHOICE (LOCAL) **6**

Turbine Mounted

-X = No Electronics - Turbine Body Only

--->>>> **1** **2** **3** **4** **5** **6**
G SC P -05175 X -X

SPECIFICATIONS

Design Type:	Turbine		
Fitting Type:	Sanitary Clamp		
Housing Material:	316 Stainless Steel		
Meter Sizes Available:	1/2" 3/4" 1" 1-1/2" 2"		
Meter ID:	1/2" --> 3/4" Fitting		
	1/2" --> 1" Fitting		
	3/4" --> 1-1/2" Fitting		
	1" --> 1-1/2" Fitting		
	1-1/2" --> 1-1/2" Fitting		
	2" --> 2" Fitting		
Flow Range:	1/2" (051)	0.8 - 6 GPM	(3.0 - 22 L/min)
	3/4" (075)	1.6 - 16 GPM	(6.0 - 60 L/min)
	3/4" (075E)	2.3 - 23 GPM	(8.7 - 87 L/min)
	1" (100)	6.7 - 67 GPM	(25 - 252 L/min)
	1-1/2"(150)	17.7 - 177 GPM	(67 - 670 L/min)
	2" (200)	33 - 330 GPM	(125 - 1250 L/min)
Accuracy (Linearity):	± 0.5%		
Repeatability:	± 0.1%		
Pressure Rating:	Limited by fitting size, clamp size and temperature.		
Operating Temperature Range:	-100° F to 225° F (-74° C to 107° C)		
Typical K-Factor:	1/2" (050)	10,000 PPG (2642 Pulses/L)	
	1/2" (051)	10,000 PPG (2642 Pulses/L)	
	3/4" (075)	3,750 PPG (991 Pulses/L)	
	3/4" (075E)	2,608 PPG (689 Pulses/L)	
	1" (100)	896 PPG (237 Pulses/L)	
	1-1/2"(150)	340 PPG (90 Pulses/L)	
	2" (200)	181 PPG (48 Pulses/L)	

*GSCP-050 requires RF Pickup

Wetted Materials:	Housing:	316 Stainless Steel	
	Sleeve Bearings:	PFTE	
	Thrust Bearings:	440C Stainless Steel	
	Shaft:	316 Stainless Steel	
	Rotor:	CD4MCu Stainless Steel	
	Rotor Supports:	316 Stainless Steel	
Retaining Rings:	300 Series Stainless Steel		
	Recommended Strainer Size:	1/2"	40 mesh (420 µm)
		3/4"	40 mesh (420 µm)
		1"	40 mesh (420 µm)
		1-1/2"	18 mesh (1000 µm)
		2"	14 mesh (1410 µm)
Frequency Output:		1/2" (050)	100 - 1000 Hz
	1/2" (051)	125 - 1000 Hz	
	3/4" (075)	100 - 1000 Hz	
	3/4" (075E)	100 - 1000 Hz	
	1" (100)	100 - 1000 Hz	
	1-1/2"(150)	100 - 1000 Hz	
	2" (200)	100 - 1000 Hz	
Calibration Report:	Comes standard with G Series meters.		
	N.I.S.T. - Certification available.		

DIMENSIONS

Meter Size	Length " (mm)	Height " (mm)
1/2"	2.75 (70)	1.63 (41)
3/4"	3.25 (82)	1.84 (47)
1"	3.56 (90)	1.84 (47)
1-1/2"	4.59 (116)	2.11 (53)
2"	6.06 (154)	2.39 (61)

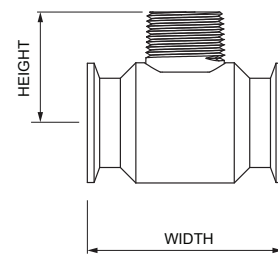

ACCESSORIES / ELECTRONICS

Part No.	Description
80001101	Weather proof enclosure - Zinc
80001105	Weather proof enclosure - SS
F Series (F018/F127/F130)	Remote Electronics

Part No.	Description
145506-01	Kit, Adapter, G Series-QSI1-Q09 Display
145506-02	Kit, Adapter, G Series-QSI2-Q09 Display
145506-03	Kit, Adapter, G Series-QSI3-Q09 Display
145506-04	Kit, Adapter, G Series-QSI1-No Display
145506-05	Kit, Adapter, G Series-QSI2-No Display
145506-06	Kit, Adapter, G Series-QSI3-No Display



5 rue des vigneron
44220 COUERON
Tél. : 02 28 03 93 90
sales@instrumentia.com
www.instrumentia.com